

Each Keller Williams office is individually owned and operated.



641 KIMBALL AVENUE
WESTFIELD, NJ

Breathtaking at every turn! This house is better than new with every inch having been renovated to perfection.

Enjoy this picture perfect 3 Bedroom, 2 Full and 2 Half Bath home with a modern farmhouse vibe on one of Westfield's most desirable northside streets. With a fabulous open floor plan and top-notch renovations and amenities everywhere you turn, 641 Kimball Avenue is an absolute dream. Stroll up the handsome bluestone walkway and take in the home's beautiful curb appeal with warm wood front steps, a welcoming front porch and a darling stacked stone façade.



The open and airy porch calls for rocking chairs, planters and summer cocktails. Enter through the stately wood front door and become transfixed by all this house has to offer. The welcoming Entry opens to the sun-drenched Living Room with a sleek built-in fireplace, soothing hues and fabulous wide planked hardwood floors that carry through the entire First Level. The Living Room opens to the outstanding Gourmet Chef's Kitchen which is every cook's dream with crisp white custom cabinetry, quartz countertops, a farmhouse sink and high-end stainless-steel appliances. A sunny Dining Area and a convenient Breakfast Bar are the perfect spots for gourmet dinners, informal get togethers or quick meals on the go.





Entertaining family and friends is delightful in the dazzling Family Room with an abundance of windows at three exposures, soothing gray hues and views of the backyard oasis beyond. A chic Powder Room, with on trend navy and gold accents, rounds out the outstanding First Level.



Ready to retire for the evening? Luxury abounds in the NEWLY BUILT private and open Master Bedroom Suite with glorious sunlight, soothing hues and hardwood floors. The suite is functionally designed with 2 enormous closets so that all your clothes will be neatly tucked away. It only gets better with the spa-like Master Bathroom complete with a to die for gray double vanity and a marble tiled oversized shower.



Two additional bedrooms are steeped in sunlight and include generous closets (1 is Walk-In) and large windows. An ultra-chic renovated Full Hall Bathroom rounds out the Second Level.

Another bonus of 641 Kimball Avenue is its darling neighborhood perfect for strolling and play. The level yard offers plenty of space for barbeques, roasting marshmallows or enjoying time with family and friends.

And that's not all. The staircase to the Lower Level leads to a spacious Recreation Room with chic wood-look floors and plenty of room for movie watching and children's arts and crafts. A cheery Laundry Room, a well-appointed Half Bath and tons of storage space round out the Lower Level.

With its prestigious neighborhood, minutes to fabulous downtown Westfield, New York City train and top-notch schools, 641 Kimball Avenue is a fantastic value and cannot be missed!



THE FLOOR PLAN

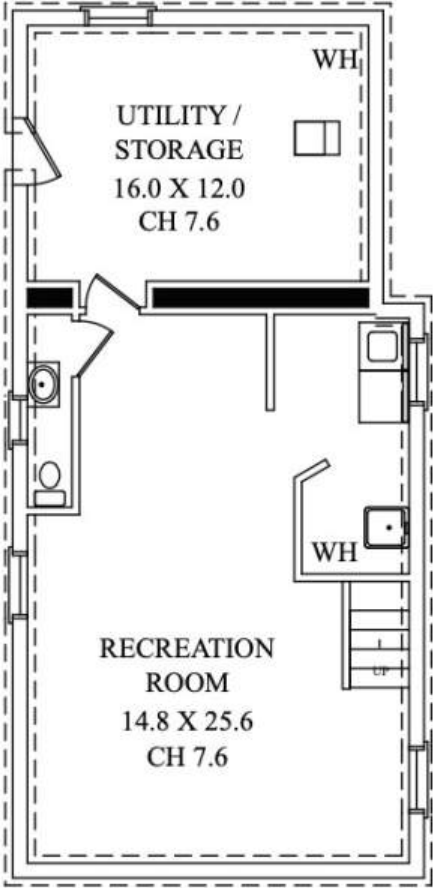

LOWER LEVEL



FIRST LEVEL

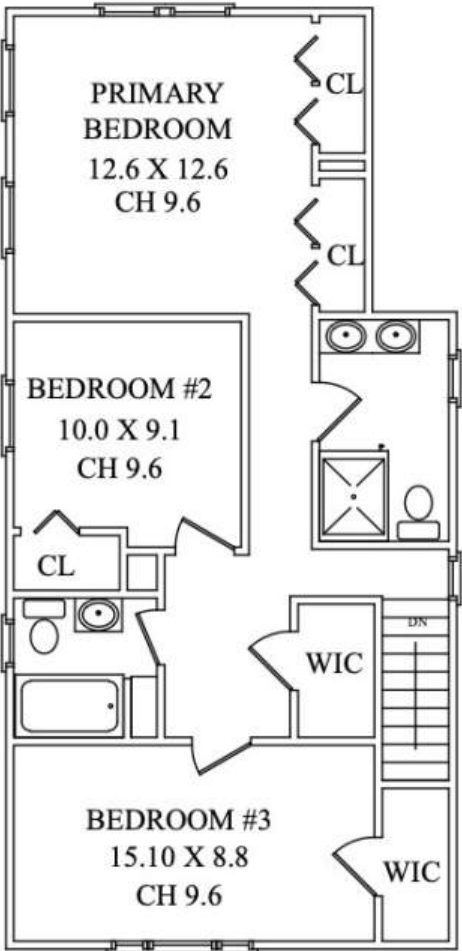

SECOND LEVEL

INSIDE & OUT

FIRST LEVEL

- Living Room featuring electric wall mount built in fireplace, recessed lighting, wide plank hardwood floors, baseboard molding, crown molding, 2 oversized windows, painted soothing gray
- Eat-In Gourmet Chef's Kitchen featuring custom wood cabinetry, quartz countertops, mosaic tile backsplash, Breakfast Bar with seating for 3, Dining Area, farm sink with commercial style faucet, open shelving, recessed lighting, pendant lighting over breakfast bar, cooktop, wall oven, built in microwave, stainless refrigerator/freezer, wide plank hardwood floors, baseboard molding, crown molding, stainless hood, painted soothing gray, open to Family Room, French door to Lower Level
- Family Room featuring wide plank hardwood floors, recessed lighting, baseboard molding, crown molding, windows at 3 exposures, painted soothing gray
- Powder Room featuring crisp navy vanity with integrated sink, wide plank hardwood floors, bead board wainscoting, baseboard molding, sconce, on trend gold fixtures and hardware

SECOND LEVEL

- Master Bedroom Suite (addition added 2020) featuring 2 Double Door Closets, windows at 2 exposures, wide plank hardwood floors, vaulted ceiling, recessed lighting, baseboard molding, crown molding, painted soothing gray
- Full Master Bath featuring marble floor tile, gray double vanity with marble countertop, sconces, baseboard molding, shower with marble tile surround and sliding glass doors
- Bedroom 2 featuring wide plank hardwood floors, recessed lighting, baseboard molding, crown molding, oversized window, painted soothing gray

- Bedroom 3 featuring wide plank hardwood floors, recessed lighting, baseboard molding, crown molding, Walk In Closet, large triple window, painted soothing gray
- Full Hall Bath featuring marble floor tile, chic gray vanity with quartz countertop, sconce, baseboard molding, tub/shower combination with marble tile surround

LOWER LEVEL

- Recreation Room featuring wood-look tile flooring, recessed lighting, baseboard molding
- Half Bath featuring tile flooring, vanity, baseboard molding
- Laundry Room featuring tile flooring, utility sink, W/D hookup
- Utility/Storage Room

FRONT AND BACKYARD

- Front Porch featuring NEW wood flooring and steps, NEW maintenance free railings, NEW columns, NEW stacked stone façade, NEW mission style front door, beadboard ceiling, flush mount lighting, string lights
- Bluestone front walkway, professional landscaping
- Level fenced in yard with professional landscaping and mature specimen trees
- Detached 2 Car Garage

ADDITIONAL FEATURES/UPGRADES (2020)

- NEW HVAC (2-zone central air)
- NEW electric throughout
- NEW plumbing throughout
- NEW windows, doors and flooring throughout
- NEW siding (house and garage)
- Google Nest (with possibility of alarm system being added)



All information deemed reliable but not guaranteed.



CELL: 973.524.0644
OFFICE: 973.376.0033 x101
EMAIL: info@sueadler.com
sueadler.com/641kimball

